

Mostec AG
Mess- und Regeltechnik
Lausenerstrasse 13a
CH-4410 Liestal
Switzerland
Tel. +41 61 921 40 90
Fax +41 61 921 40 83
Internet www.mostec.ch
E-Mail info@mostec.ch

MOSTEC

Room Thermostat Typ M2135



Technical description

The accurate wall mountable M2135 directly with the analog inputs of the house control system, a control computer, or a controller. The is a temperature transducer with build-in platinum sensor for a customized measuring range within -50 to 50°C. It can be used e.g. as room thermostat, for individual temperature selection in the office or apartment. A typical measuring range is 10... 30°C. In the same housing is also a potentiometer with rotary button, galvanically isolated from the temperature transducer. Both output signals are 4... 20mA for the selected measuring range, respectable for the whole range of rotation of the setpoint potentiometer. The signal circuits are implemented as 2-wire system to ease interfacing the thermostat

produces practically no heat and does therefore not affect the temperature sensor circuit. Applications are equipments in refrigerating chambers, office and residential buildings; everywhere, where low costs with high accuracy is required

Technical data:

| | |
|-------------------------------|--|
| Temperature sensor: | Pt-1000 sensor with 1000 Ω at 0°C per DIN 43 760, 2-wire system |
| Signal output: | 4...20mA for any temperature range within -50 and +50°C, 2-wire system |
| Setpoint output: | 4...20mA for the full potentiometer turning angle with knob on potentiometer, 240° turning angle |
| Adjusting the setpoint: | the setpoint and the sensor circuit are galvanically isolated from each other |
| Galvanic isolation: | |
| Supply voltage: | 24VDC@500ohm load, min. 11VDC, max. 33VDC |
| Max. dissipation: | 1,2W |
| Accuracy: | 0,5% |
| Reproducibility: | < 0,1% |
| Temperature coefficient: | zero typical 60ppm/°C span typical 55ppm/°C |
| Long term stability: | < 0,15% after 3 months |
| Working temperature range: | -50 to 50°C |
| Max. humidity: | 95%, non condensing |
| Max. lengths of signal lines: | 2000m, 2-conductor |
| Max. load: | 500 |
| CE-conformity: | fulfilled |
| Calibration: | per DIN, $\pm 0,1\%$ |
| Connection: | two 2-pole screw terminals mechanically secured |
| Delivery time: | from stock, independent of the required measuring range |
| Warranty: | 2 years |
| Options: | - connecting cable - customer specific requirements |
| Order example: | M2135 for 10 ... 30°C |

Dimensions:

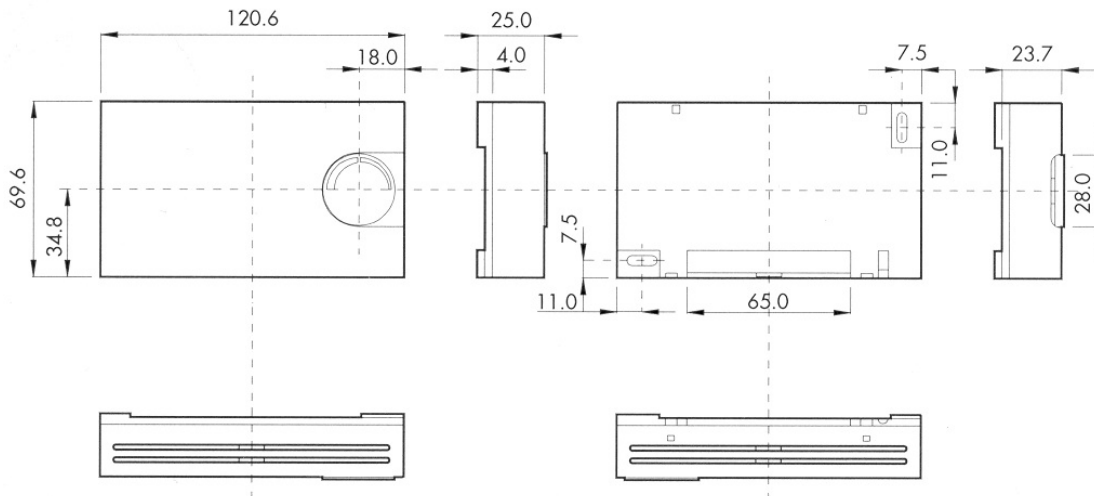

how to open the case:



Connection:

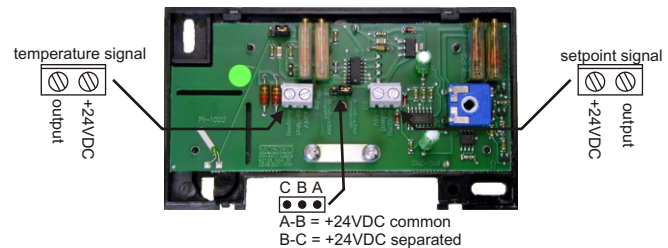

MOSTEC

Mess- und Regeltechnik
Lausenerstrasse 13a
CH-4410 Liestal
Switzerland
Tel. +41 61 921 40 90
Fax +41 61 921 40 83